



# SHELTER Fob by BEST

## Quickly initiate a lockdown and send notification of lockdown event to a third party.\*

The BEST fob allows you to quickly and easily lockdown your building via the SHELTER™ 900 MHz secure wireless network. With assistance from your integration resource, the SHELTER network components can be configured so the fob initiates a signal to your existing access control system or alarm system, allowing communication with first responders. The simple press of a button can initiate a series of events that makes your facility safer and more responsive to emergency situations.

### A solid defense against active aggressors.

Lockdown is initiated via individual fobs that are connected to repeaters in the building. Fobs can be configured to a single lock, a group of locks or the entire facility. Visual indicators and a configurable audible alarm help communicate lockdown status (per lock) throughout the building.

- **Wireless solution.** SHELTER easily retrofits to existing doors in buildings new and old.
- **Scalable.** SHELTER can fit almost any-size building or campus.
- **Affordable.** SHELTER is more cost-effective than standard wired solutions.
- **Versatile.** SHELTER IS Available for cylindrical and mortise locks.

SHELTER has been repeatedly acclaimed for its effectiveness, especially as it relates to school lockdown strategies. It's been awarded time and time again as a standout product and has been featured in multiple trade magazines.



\*SHELTER can be connected to an existing third-party alarm system to notify first responders.

SHELTER—a unique combination of code-compliant hardware and proven technology—is a responsive lockdown solution ideal for all types of buildings / environments and budgets.

**BEST SHELTER helps you create safe spaces within your facility quickly and safely.**

This wireless responsive lockdown solution can be fully configured to adapt to your building(s) and security protocol. With SHELTER, you can be confident your building is ready to respond in any situation. Integrating with first response systems and electronic access control systems, SHELTER is built to be an integral part of any building security system.

SHELTER Fob Specifications	
<b>Wireless Communications</b>	900 MHz; Range of 200 ft. indoors (typical)*
<b>Buttons</b>	<b>Large lockdown button:</b> Press top button for up to 1 second until red flashing begins <b>Small test button:</b> Press bottom button for up to 1 second until red flashing begins
<b>Capability</b>	Configurable to a single lock, a group or the entire facility
<b>Dimensions</b>	1.7 x 3.1 inches
<b>Weight</b>	1.4 oz.
<b>Maximum Range</b>	200 ft. indoors (typical)*
<b>Code Compliance</b>	FCC Part 15 B&C
<b>Material</b>	Polycarbonate Protective button cover to prevent false alarms
<b>Battery</b>	Standard 3V CR2450 battery Up to 3-year battery life
<b>Color</b>	Black

\*Wireless range will vary based on application, operating environment, building materials and external factors.

SHELTER : A Responsive Lockdown Solution

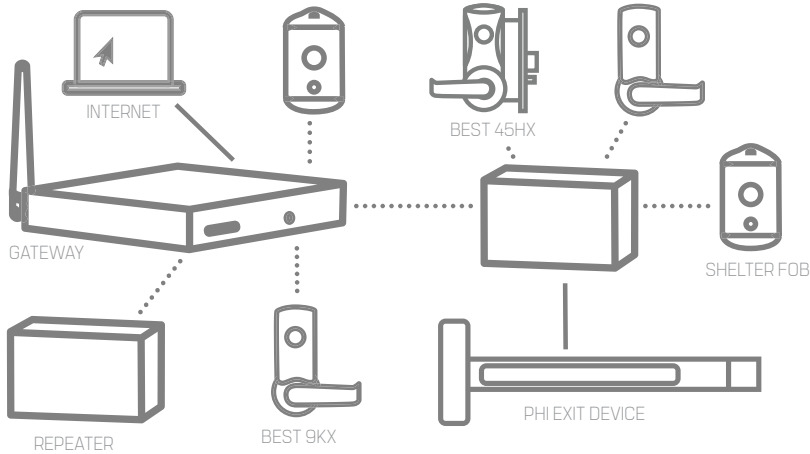

**Features**

- FOB**
- Two Buttons: Lockdown and Test (with LED).
  - Range: 200 ft. indoors (typical).
  - Visual Indicators: LED indication under buttons.
  - Initiate Lockdown: Press and hold 1 second to initiate lockdown; lockdown cannot be canceled via the fob.
  - Test / Confirm Connection: Press and hold for 1 second.
  - Protective Cover: Prevents false alarms.
  - Scalable Solution: Fob can lock a single door, set of doors or entire system.

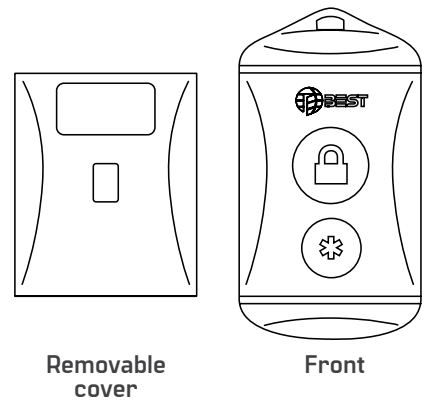

Our site survey tools may provide an initial recommendation on products needed, however it is recommended that you work with a thirdparty integrator to understand final system requirements and capabilities in order to ensure proper performance of your system.

For questions about ordering and to be sure you get the right configuration for your needs, [contact your BEST dormakaba sales representative.](#)  
6161 East 75th Street, Indianapolis, IN 46250 USA | [855-365-2407](tel:855-365-2407) | [bestaccess.com](http://bestaccess.com)